



McElroy Manufacturing, Inc.

The leader by design.

Tulsa, Oklahoma U.S.A.

DRAWN:

MCB

CHECK:

BOC

APPRVD:

DWP

DATE:

6/20/13

SHT

No:

1

REV

No:

B

PART

No:

A4845400

IN-DITCH 48 FUSION MACHINE PACKAGE

NOTE: THIS DRAWING AND THE INFORMATION CONTAINED THEREIN IS THE CONFIDENTIAL AND PROPRIETARY PROPERTY OF McElroy Manufacturing, Inc. THE DRAWING IS NOT TO BE REPRODUCED IN ANY MANNER, SUBMITTED TO OUTSIDE PARTIES FOR EXAMINATION, OR USED DIRECTLY OR INDIRECTLY FOR THE PURPOSES OF OTHER THAN THOSE FOR WHICH IT WAS FURNISHED WITHOUT WRITTEN PERMISSION OF McElroy Manufacturing, Inc.

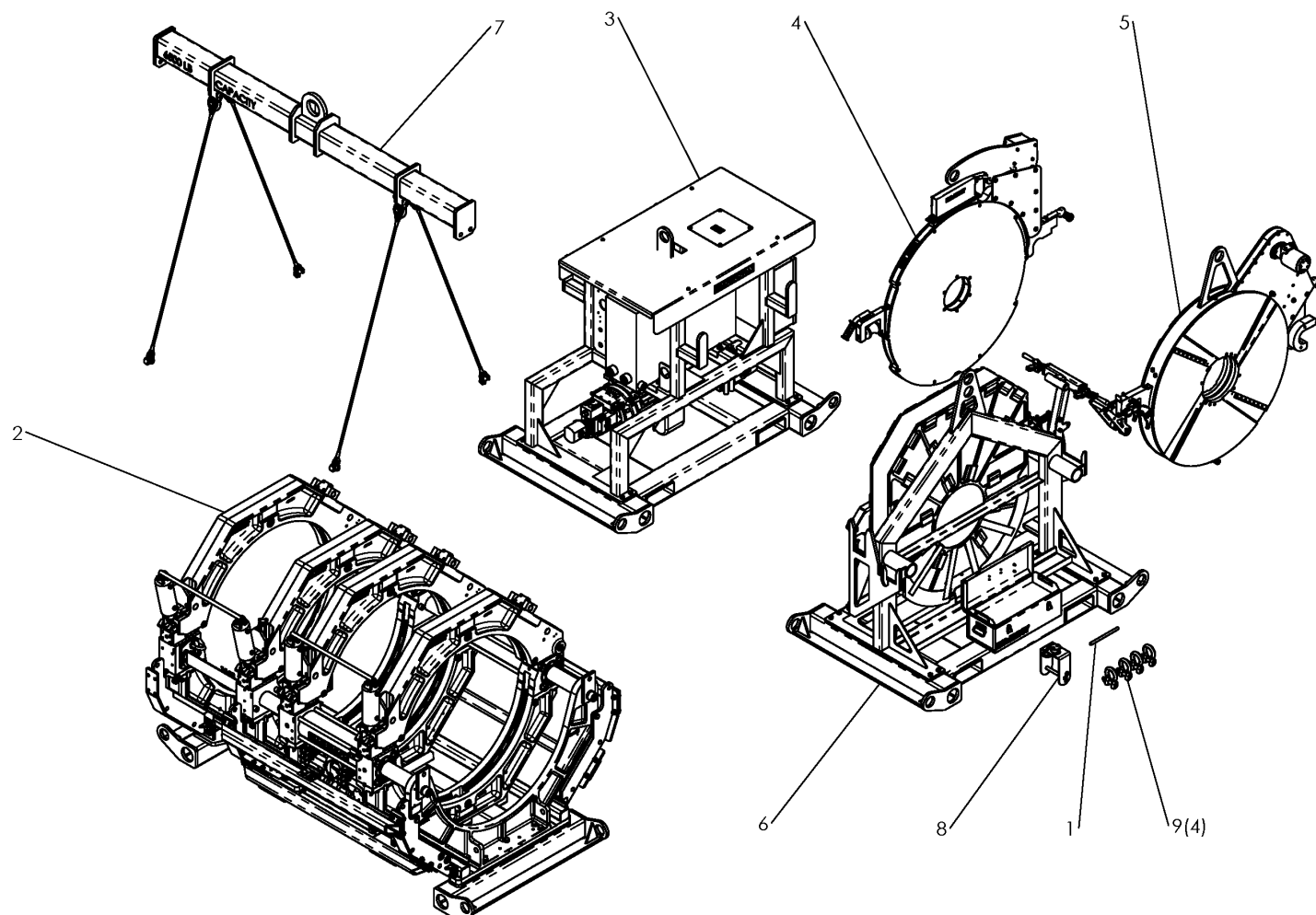

McElroy Manufacturing Parts List

Part Number: A4845401 In-Ditch 48 HF 240V Fusion Machine Package

Part Number A4845401 Component List

| Item | Component | Description | Quantity | Unit | Price |
|------|-----------|--|----------|------|------------|
| 1 | 4845201 | Pin Drift Punch | 1.0 | EA | 174.00 |
| 2 | 4845501 | In-Ditch 48 HF Carriage Assembly | 1.0 | EA | 0.00 |
| 3 | 4846101 | In-Ditch 48 240V Power Pack Assembly | 1.0 | EA | 105,817.00 |
| 4 | 4846501 | In-Ditch 48 240V Heater Assembly (Effective to 10/25/15) | 1.0 | EA | 0.00 |
| 4 | 4846502 | In-Ditch 48 240V Heater Assembly | 1.0 | EA | 0.00 |
| 5 | 4846601 | In-Ditch 48 Facer Assembly | 1.0 | EA | 0.00 |
| 6 | 4846801 | In-Ditch 48 Heater/Facer Stand Assembly | 1.0 | EA | 0.00 |
| 7 | 4853501 | In-Ditch 48 Spreader Bar Assembly | 1.0 | EA | 7,068.00 |
| 8 | 4853701 | Upr Jaw Lift Brkt Assy | 1.0 | EA | 677.00 |
| 9 | MJD00023 | 7/8 , 9-1/2 Ton Shackle | 4.0 | EA | 148.00 |

Please visit <https://fusion.mcelroy.com/parts> to purchase parts or for more information.