



McElroy Manufacturing, Inc.
The leader by design.
Tulsa, Oklahoma U.S.A.

DRAWN: AH

CHECK: TLW

APPRV'D: SWB

DATE: 3/5/99

SHT No: 1

REV No: A

PART No: ASW10301

Sidewinder™ CHAIN CLAMP ASSEMBLY

NOTE: THIS DRAWING AND THE INFORMATION CONTAINED THEREIN IS THE CONFIDENTIAL AND PROPRIETARY PROPERTY OF McElroy Manufacturing, Inc. THE DRAWING IS NOT TO BE REPRODUCED IN ANY MANNER, SUBMITTED TO OUTSIDE PARTIES FOR EXAMINATION, OR USED DIRECTLY OR INDIRECTLY FOR THE PURPOSES OTHER THAN THOSE FOR WHICH IT WAS FURNISHED WITHOUT WRITTEN PERMISSION OF McElroy Manufacturing, Inc.

NOTES:

1. ITEMS SHOWN IN PARENTHESIS REFLECT LOCAL QUANTITIES AND MAY NOT REFLECT TOTAL ASSEMBLY QUANTITIES.

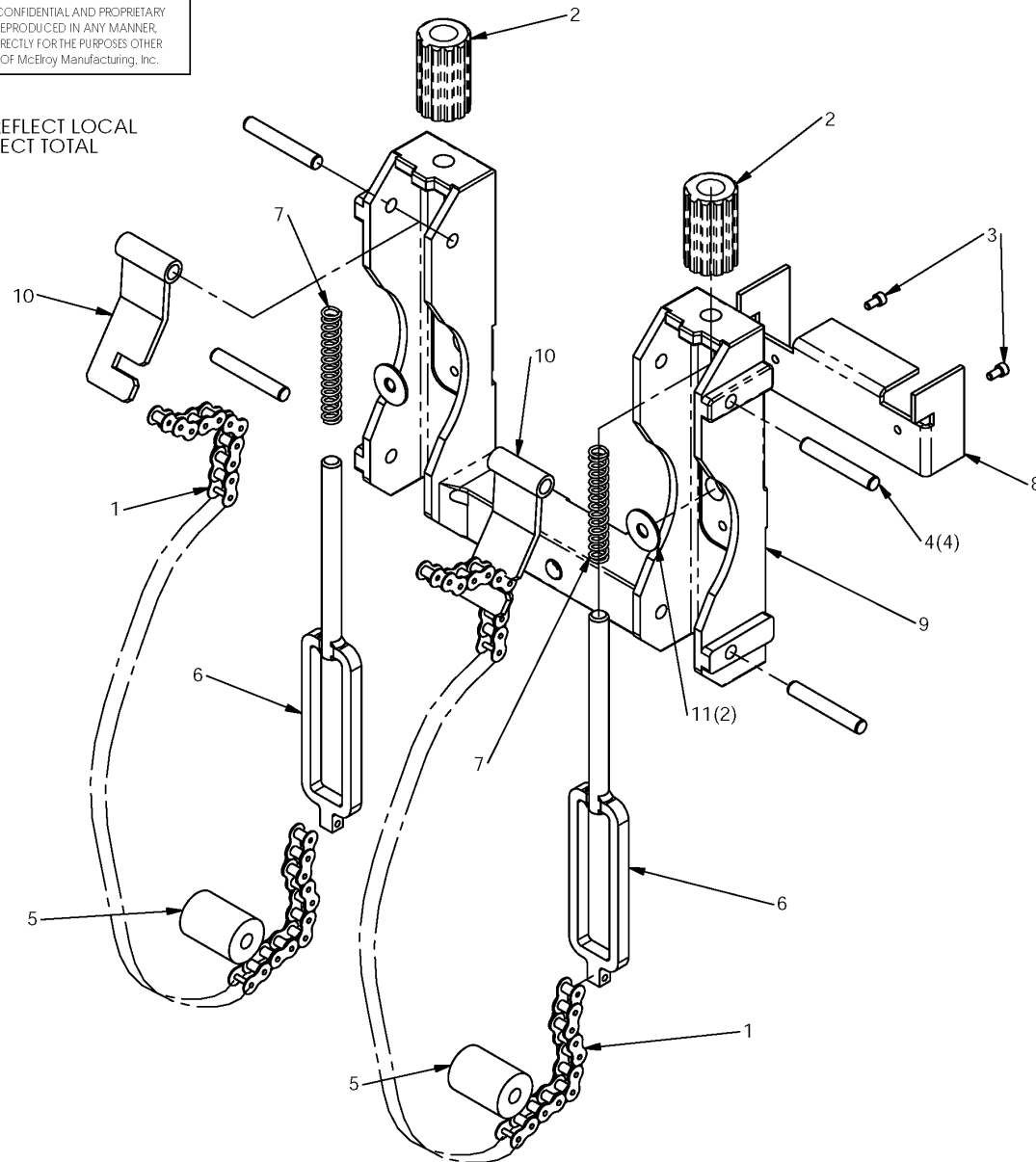

McElroy Manufacturing Parts List

Part Number: ASW10301 Sidewinder Chain Clamp Assembly

Part Number ASW10301 Component List

Item	Component	Description	Quantity	Unit	Price
1	A213601	Sidewinder/2/14/28 Tailstock Chain Assembly	2.0	EA	35.24
2	A829001	Short Clamp Knob Assembly	2.0	EA	86.71
3	MAC00035	#10-24NCX3/8LG Shcs PL	2.0	EA	0.48
4	MCK00027	3/8DIAX2-3/4LG Lck Pin Stl PL	4.0	EA	4.52
5	SW01601	Roller	2.0	EA	13.55
6	SW01901	Chain Take-up Attachment	2.0	EA	117.00
7	SW02101	Compression Spring	2.0	EA	4.70
8	SW03401	SW Htr Guide	1.0	EA	69.34
9	SW05703	Tailstock	1.0	EA	467.00
10	401701	Chain Hook	2.0	EA	44.85
11	MBG00012	3/8 Flat Washer Stl	2.0	EA	1.93

Please visit <https://fusion.mcelroy.com/parts> to purchase parts or for more information.