



McElroy Manufacturing, Inc.  
The leader by design.  
Tulsa, Oklahoma U.S.A.

DRAWN:

BWW

CHECK:

SWB

APPRVD:

SWB

DATE:

10/25/05

SHT  
No: 1

REV  
No: A

PART  
No: ASW00123

### 300psi COMPACT CHAIN CLAMP SideWinder™ ASSEMBLY

NOTE: THIS DRAWING AND THE INFORMATION CONTAINED THEREIN IS THE CONFIDENTIAL AND PROPRIETARY PROPERTY OF McElroy Manufacturing, Inc. THE DRAWING IS NOT TO BE REPRODUCED IN ANY MANNER, SUBMITTED TO OUTSIDE PARTIES FOR EXAMINATION, OR USED DIRECTLY OR INDIRECTLY FOR THE PURPOSES OTHER THAN THOSE FOR WHICH IT WAS FURNISHED WITHOUT WRITTEN PERMISSION OF McElroy Manufacturing, Inc.

#### NOTES:

1. FOR REPLACEMENT GAUGE ORDER KIT ASW13104, WHICH INCLUDES GAUGE AND INSTRUCTION SHEETS.

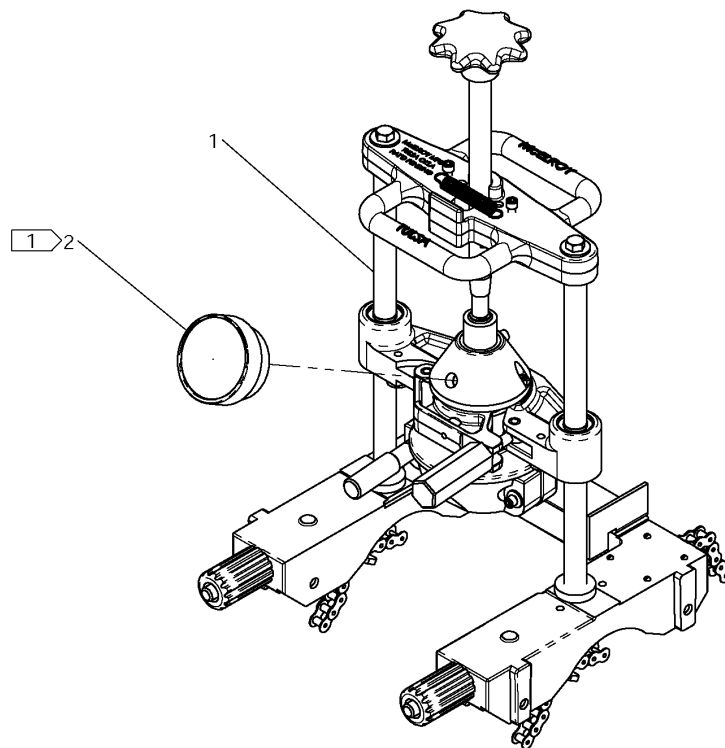

## McElroy Manufacturing Parts List

**Part Number:** ASW00123 300psi Compact Chain Clamp Sidewinder Assembly

### Part Number ASW00123 Component List

Item	Component	Description	Quantity	Unit	Price
1	ASW00124	Compact Chain Clamp Sidewinder Assembly Less Gauge	1.0	EA	2,774.00
2	MEE00047	300PSI/BAR,1% Pressure Gauge	1.0	EA	104.00

Please visit <https://fusion.mcelroy.com/parts> to purchase parts or for more information.