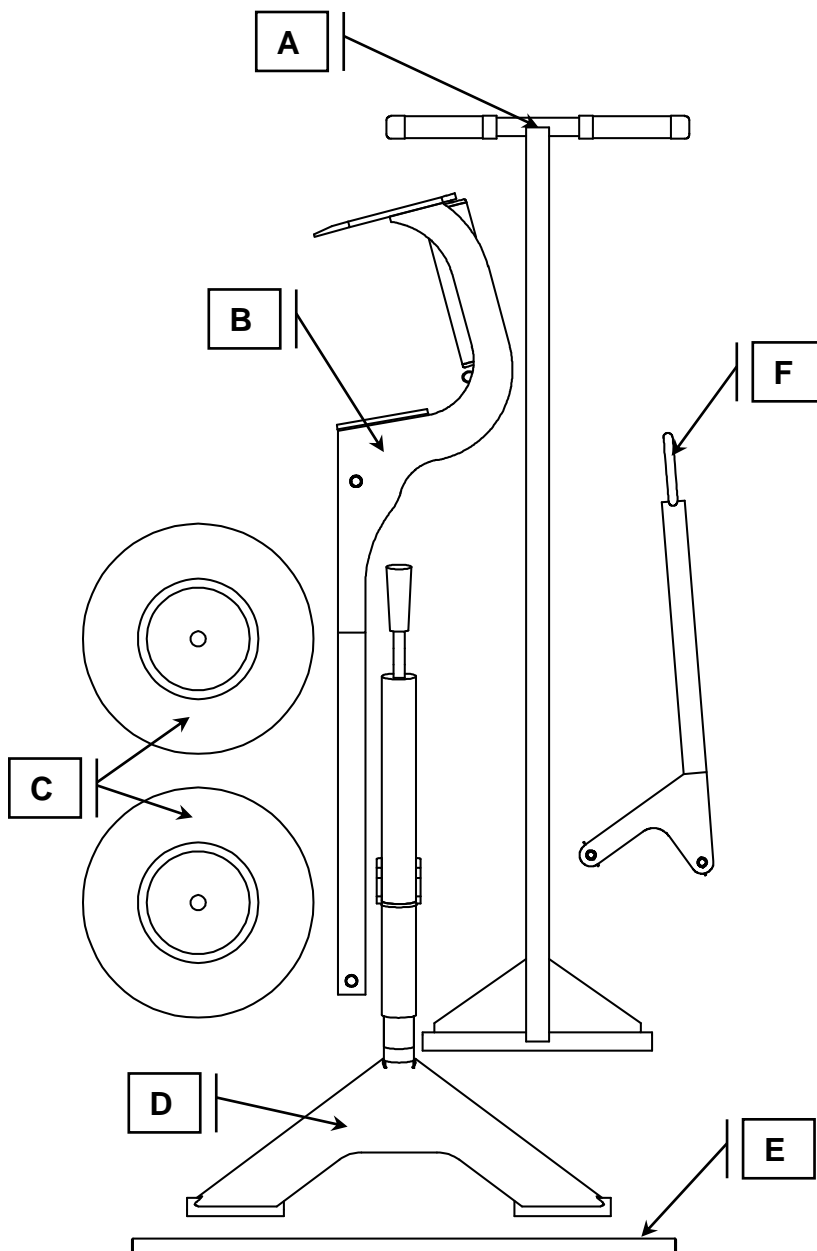

**PolyPorter® Assembly and Operation Instructions****Assembly Instructions:**

Make sure you have received these parts  
and one Hardware bag including:

- 1 -long pin with E ring
- 1 -short pin with E ring
- 2 -E rings
- 2 -3/8" bolts
- 2 -3/8" lock washers
- 2 -3/8" flat washers
- 2 -pull pins
- 2 -hair pins

- A. Handle Assembly
- B. Hook Arm
- C. Wheels
- D. Jack Assembly
- E. Axle
- F. Leg Assembly

**Tools Required for Assembly:**

9/16 wrench/socket wrench  
Slip Joint Pliers

**PolyPorter® Assembly and Operation Instructions**

1. Lineup the tubes on the handle and jack assemblies and insert the axle through them.
2. Slip the wheels over the ends of the axle and secure with a bolt, lock and flat washers.
3. Align the hole in the hook arm with the bracket on the jack and install the long pin and 'E' rings
4. Align rear hole in the hook arm with upper hole in the arm assembly and install the other pin and 'E' rings
5. Align the hole in the leg assembly with the lower hole in the arm assembly and install a clevis and lock with a hair pin. Refer to the illustration to determine the proper orientation. The second clevis pin installs above the handle tube.

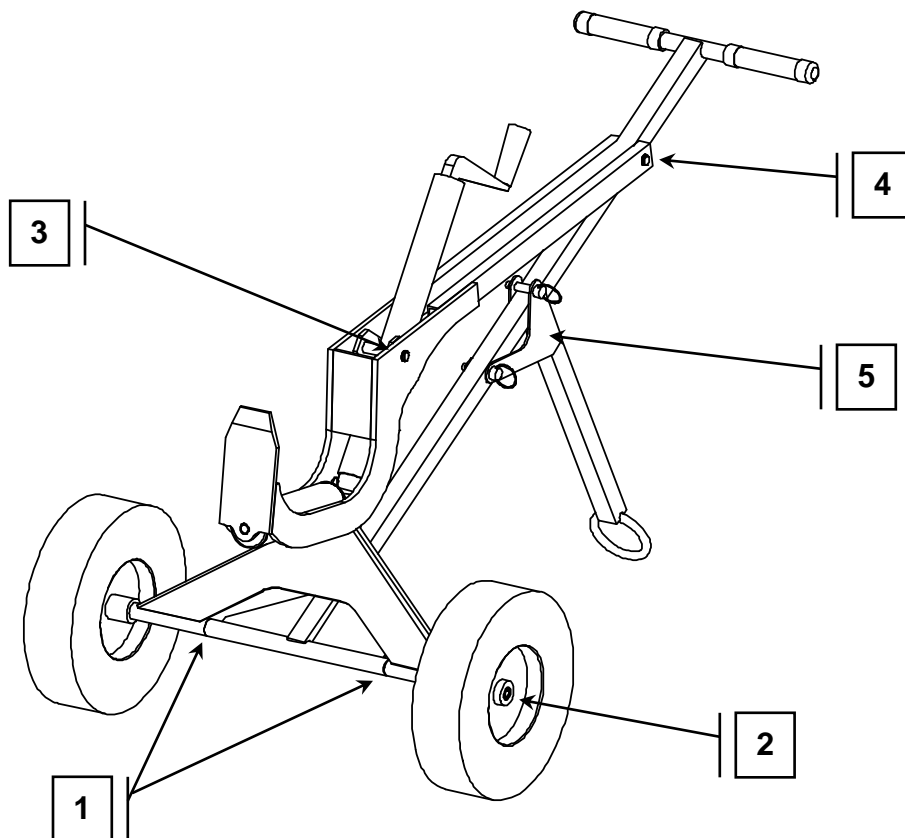

**PolyPorter® Assembly and Operation Instructions****Operation:**

**NOTICE:** Read and Understand these Instructions before using.

**CAUTION** Never use with damaged or missing parts. Operate on solid ground. Brace foot on axle when raising or lowering pipe. Lifting handle too high when moving pipe can overturn load. Maximum Capacity 8" DIPS (250mm) and 300 lbs.

**Raising the pipe**

Adjust the jack to the lowest position. Lift the handle until the hook is flat on the ground beside the pipe. Slide the hook under the pipe. Placing your foot on the axle, pull the handle back and down until the leg rest is on the ground. Adjust the pipe height, using the jack, and the pipe position by lifting the handle slightly and rolling the unit forward or backward until it is aligned with the fusion machine. Two PolyPorters may be used to lift a 40 or 50 foot section of pipe and align it with the fusion machine.

Once the jack is adjusted to the correct height you may be able to pickup pipe at that setting. There may be cases when you don't have enough leverage to lift the pipe (unusually heavy wall or unusually high adjustment). If this happens, crank the jack down before picking up the pipe. Lift the pipe, and then crank it up to align with the machine.



PH02523-08-07-03

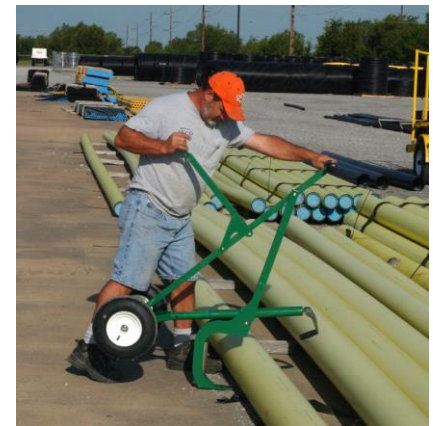

PH02521-08-07-03



PH02522-08-07-03



PH02556-08-14-03

**PolyPorter® Assembly and Operation Instructions****Operation (cont.):**

**⚠ CAUTION** Brace foot on axle when raising or lowering pipe. Lifting handle too high when moving pipe can overturn load.

**Lowering the pipe**

Lower the height adjustment. Lift the handle slightly, until you can rest your foot on the axle. Continue lifting the handle until the pipe rest is on the ground. Slide the PolyPorter out from under the pipe.



PH02522-08-07-03



PH02521-08-07-03

**Maintenance:**

The unit's few moving parts make maintenance minimal.

Before use, be sure the wheel bolts are tight, the tires are properly inflated (32 psi) and that the pivot and detent pins are securely in place. Do not use if any components are missing or broken.



PH02555-08-14-03

## DRAWING REVISION HISTORY LISTING

**PART NO:** 86420101

**DESCRIPTION:** PolyPorter® Assembly and Operation Instructions

<u>APPR.</u>	<u>REV</u>	<u>DATE</u>	<u>BY</u>	<u>DESCRIPTION OF REVISION</u>
MRP	B	4/30/14	SRB	REVISED "TM" TO ON THE PolyPorter to "®" & REVISED THE McELROY LOGO BLOCK AT THE END OF THE SHEET TO THE CORRECT WEB ADDRESS.