



McElroy Manufacturing, Inc.

The leader by design.

Tulsa, Oklahoma U.S.A.

DRAWN:

RLT

CHECK:

BOC

APPRVD:

PJD

DATE:

4/30/18

SHT

No: 1

REV

No: A

PART

No:

2495501_5701_5901

HEATER BAG ASSEMBLY

NOTE: THIS DRAWING AND THE INFORMATION CONTAINED THEREIN IS THE CONFIDENTIAL AND PROPRIETARY PROPERTY OF McElroy Manufacturing, Inc. THE DRAWING IS NOT TO BE REPRODUCED IN ANY MANNER, SUBMITTED TO OUTSIDE PARTIES FOR EXAMINATION, OR USED DIRECTLY OR INDIRECTLY FOR THE PURPOSES OTHER THAN THOSE FOR WHICH IT WAS FURNISHED WITHOUT WRITTEN PERMISSION OF McElroy Manufacturing, Inc.

NOTES:

1. APPLY MEDIUM STRENGTH THREAD RETAINING COMPOUND.

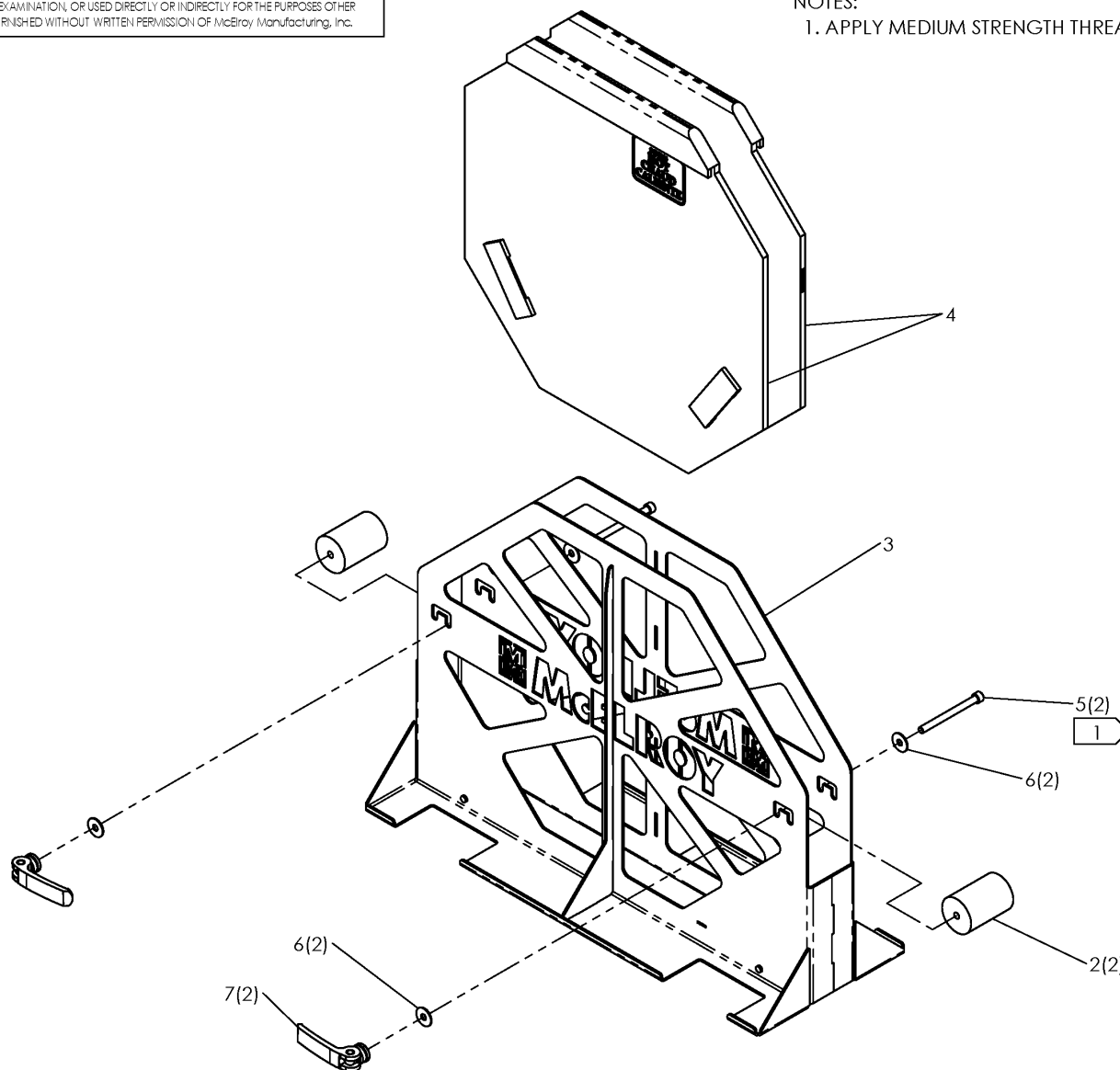

McElroy Manufacturing Parts List

Part Number: 2495901 630mm Heater Bag Assembly

Part Number 2495901 Component List

Item	Component	Description	Quantity	Unit	Price
1	2495301	Guide Rod Pin (Effective to 11/5/18)	2.0	EA	0.00
2	2495401	Heater Bag Guide Rod	2.0	EA	0.00
3	2496001	630MM Heater Bag Wld	1.0	EA	0.00
4	2496005	630MM Heater Panel	2.0	EA	564.00
5	MAH00097	1/4-20NCX1/2LG Bhscs SS (Effective to 11/5/18)	2.0	EA	0.41
5	MAC00463	3/8-16NCX4-1/4LG Shcs	2.0	EA	5.95
6	MBG00031	1/4 Fender Washer Stil PL (Effective to 11/5/18)	4.0	EA	0.31
6	MBF00007	3/8 TY 'a' Wide FL Wshr Stil PL	4.0	EA	0.11
7	MJA00025	Cam Handle (Effective to 11/5/18)	2.0	EA	0.00
7	MJA00027	Eccentric Cam Clamping Lever	2.0	EA	43.43

Please visit <https://fusion.mcelroy.com/parts> to purchase parts or for more information.