



McElroy Manufacturing, Inc.
The leader by design.
Tulsa, Oklahoma U.S.A.

DRAWN: LBK

CHECK: BLM

APPRV'D: DWP

DATE: 7/31/06

SHT No: 1

REV No: B

PART No: 1875501

POLYHORSE PACKAGE WITH MANUAL FRONT ROLLER

NOTE: THIS DRAWING AND THE INFORMATION CONTAINED THEREIN IS THE CONFIDENTIAL AND PROPRIETARY PROPERTY OF McElroy Manufacturing, Inc. THE DRAWING IS NOT TO BE REPRODUCED IN ANY MANNER, SUBMITTED TO OUTSIDE PARTIES FOR EXAMINATION, OR USED DIRECTLY OR INDIRECTLY FOR THE PURPOSES OTHER THAN THOSE FOR WHICH IT WAS FURNISHED WITHOUT WRITTEN PERMISSION OF McElroy Manufacturing, Inc.

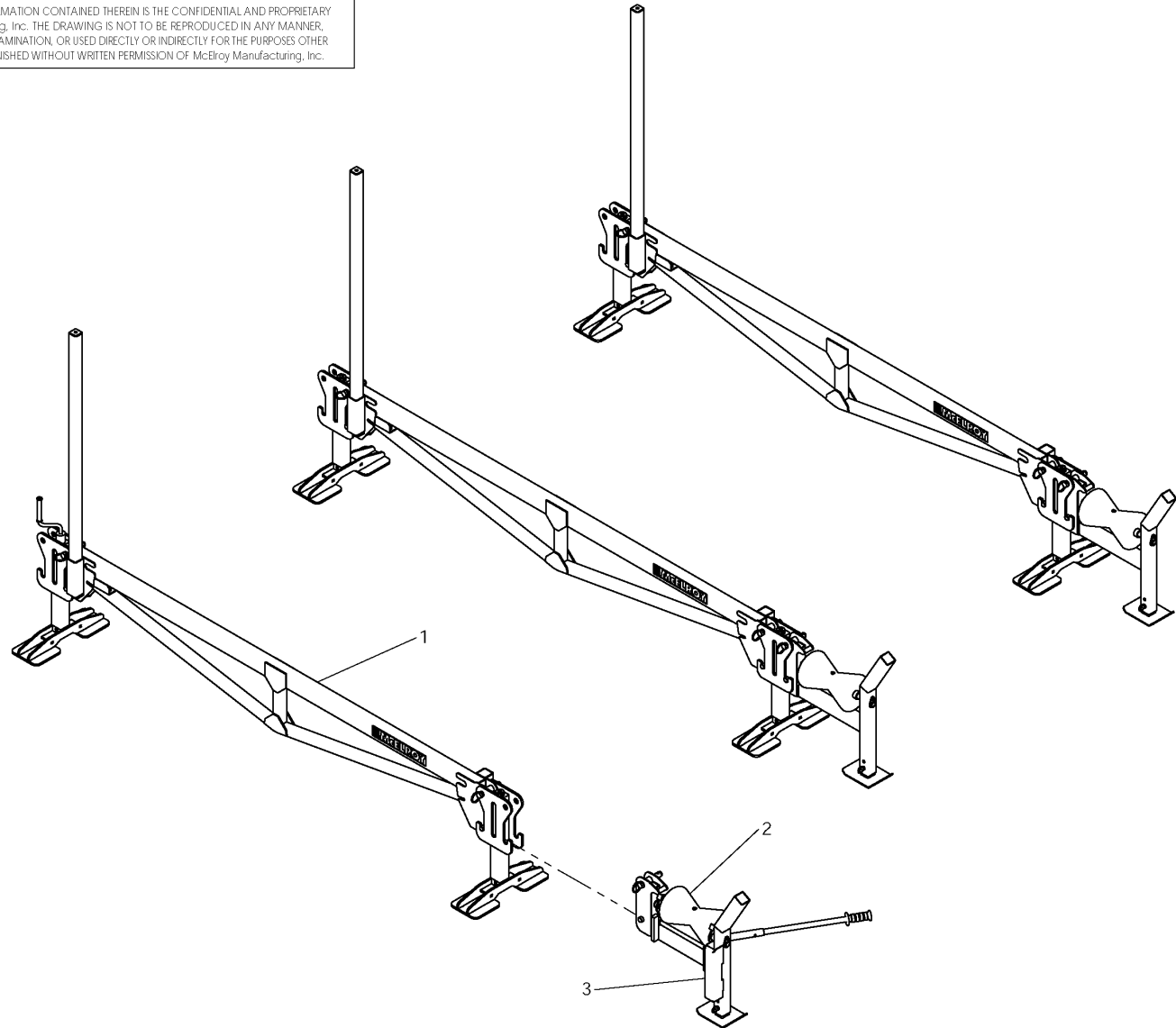

UNLESS NOTED OTHERWISE: (3) PLC. DIM'S .XXX = ±0.005" (2) PLC. DIM'S .XX = ±0.010" FRACTIONAL DIM'S = ±1/32" ANGULAR DIM'S = ±1/4° REMOVE ALL BURRS BREAK ALL SHARP EDGES STAMP OR ETCH P/N ON ALL DETAIL PARTS

| MMI NUMBER | ITEM | QTY. | SIZE AND DESCRIPTION |
|------------|------|------|----------------------|
| | | | |

McElroy Manufacturing Parts List

Part Number: 1875501 Polyhorse Package with Manual Front Roller

Part Number 1875501 Component List

| Item | Component | Description | Quantity | Unit | Price |
|------|-----------|--------------------------------------|----------|------|-----------|
| 1 | 1875503 | Polyhorse Assembly less Front Roller | 1.0 | EA | 11,353.00 |
| 2 | 1876301 | Pivot Roller Support Assembly | 1.0 | EA | 2,424.00 |
| 3 | 1877501 | Polyhorse Operator's Manual | 1.0 | EA | 0.00 |

Please visit <https://fusion.mcelroy.com/parts> to purchase parts or for more information.

