



McElroy Manufacturing, Inc.
The leader by design.
Tulsa, Oklahoma U.S.A.

DRAWN: PJD CHECK: BLM APPRVD: DWP DATE: 8/05/10 SHT No: 1A REV No: G PART No: 4839101

MegaMc™ Polyhorse™ VALVE MANIFOLD ASSEMBLY

NOTE: THIS DRAWING AND THE INFORMATION CONTAINED THEREIN IS THE CONFIDENTIAL AND PROPRIETARY PROPERTY OF McElroy Manufacturing, Inc. THE DRAWING IS NOT TO BE REPRODUCED IN ANY MANNER, SUBMITTED TO OUTSIDE PARTIES FOR EXAMINATION, OR USED DIRECTLY OR INDIRECTLY FOR THE PURPOSES OTHER THAN THOSE FOR WHICH IT WAS FURNISHED WITHOUT WRITTEN PERMISSION OF McElroy Manufacturing, Inc.

NOTES:

1. VALVES MUST BE INSTALLED IN POSITIONS SHOWN. SEE SHEET 2 FOR CLARIFICATION. COVER PLATES MUST BE REINSTALLED IN CORRECT POSITIONS.
2. ONE PLUG SUPPLIED WITH ITEM 22 (MEL00038), TWO PLUGS TO BE INSTALLED AT ASSEMBLY.

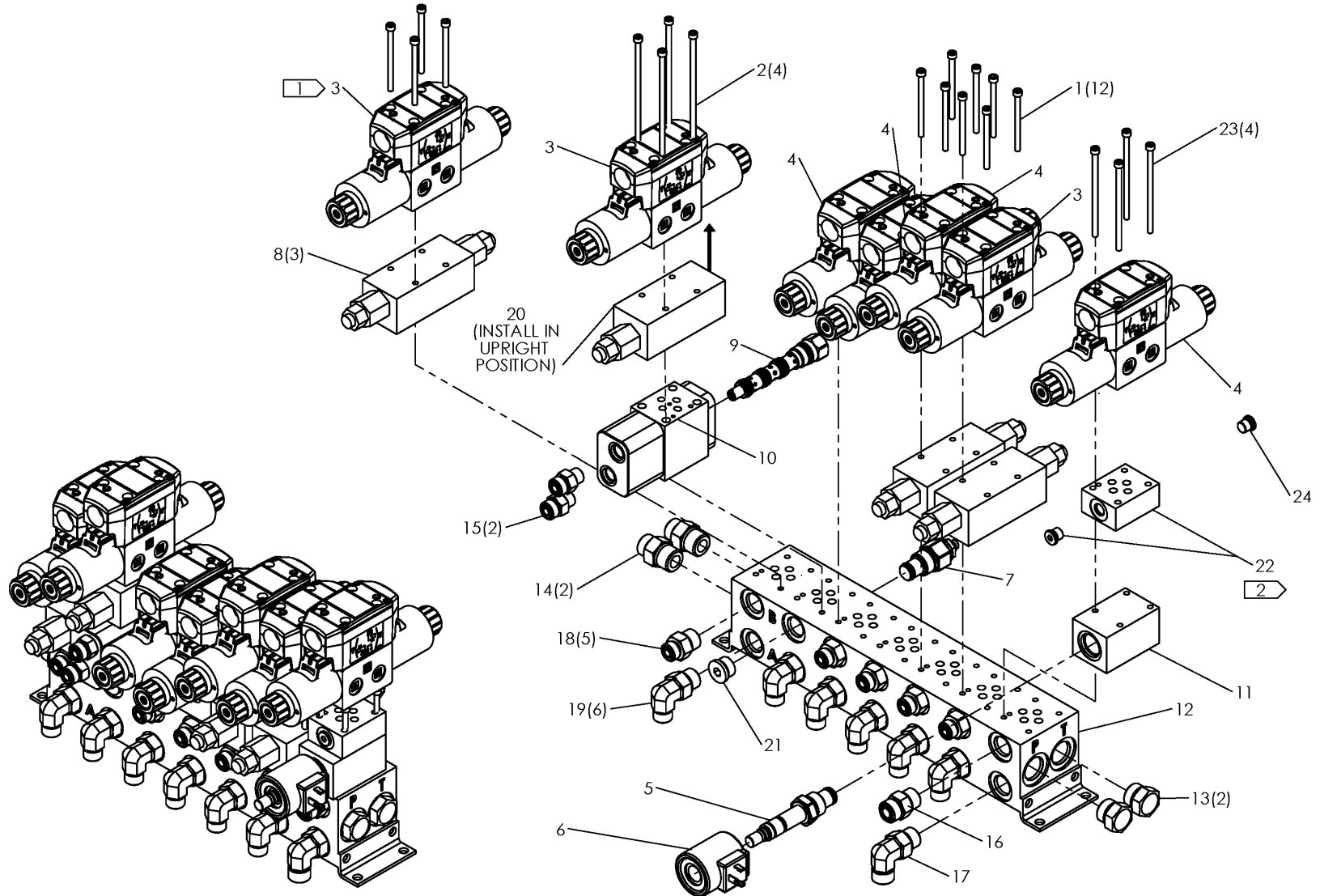



McElroy Manufacturing, Inc.

The leader by design.

Tulsa, Oklahoma U.S.A.

DRAWN: PJD

CHECK: BLM

APPRVD: DWP

DATE: 8/05/10

SHT No: 1B

REV No: G

PART No: 4839101

MegaMc™ Polyhorse™ VALVE MANIFOLD ASSEMBLY

NOTE: THIS DRAWING AND THE INFORMATION CONTAINED THEREIN IS THE CONFIDENTIAL AND PROPRIETARY PROPERTY OF McElroy Manufacturing, Inc. THE DRAWING IS NOT TO BE REPRODUCED IN ANY MANNER, SUBMITTED TO OUTSIDE PARTIES FOR EXAMINATION, OR USED DIRECTLY OR INDIRECTLY FOR THE PURPOSES OTHER THAN THOSE FOR WHICH IT WAS FURNISHED WITHOUT WRITTEN PERMISSION OF McElroy Manufacturing, Inc.

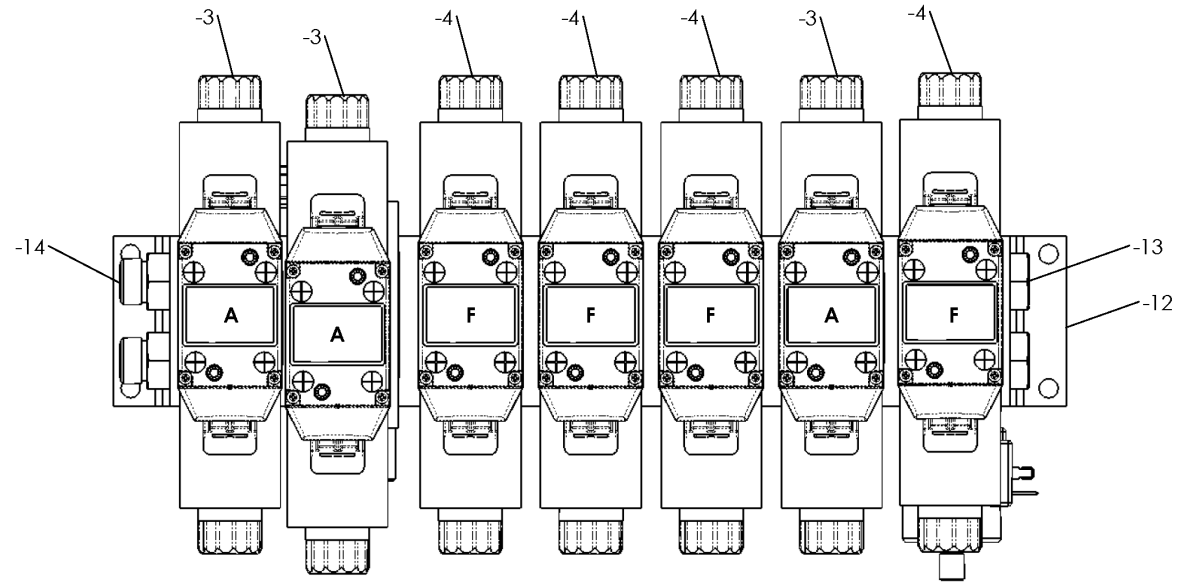

TOP VIEW

A = VALVE WITH CLOSED-CENTER SPOOL

McElroy P/N	VENDOR P/N EXAMPLE
MEF00210	VSD03M-3A-AWDB-75L

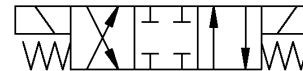

F = VALVE WITH OPEN-CENTER SPOOL

McElroy P/N	VENDOR P/N EXAMPLE
MEF00211	VSD03M-3F-AWDB-75L



McElroy Manufacturing Parts List

Part Number: 4839101 MegaMc Polyhorse Valve Manifold Assembly

Part Number 4839101 Component List

Item	Component	Description	Quantity	Unit	Price
1	MAC00045	#10-24NCX2-1/2LG Shcs (Effective to 1/27/25)	12.0	EA	0.94
1	MAC00460	#10-24NCX2-3/4LG Shcs PL	12.0	EA	0.00
2	MAC00436	#10-24NCX5LG Shcs SS (Effective to 1/27/25)	4.0	EA	0.00
2	MAC00468	#10-24NCX5-1/4LG Shcs	4.0	EA	0.00
3	MEF00210	Directional Valve	3.0	EA	1,039.00
4	MEF00211	Directional Valve	4.0	EA	823.00
5	MEF00212	2WAY NC Sol Valve Cartridge	1.0	EA	248.00
6	MEF00213	10SIZE 12VDC E-coil	1.0	EA	0.00
7	MEH00015	Relief Valve	1.0	EA	0.00
8	MEJ00001	Flow Control Valve	3.0	EA	599.00
9	MEJ00052	Flow Divider Cartridge	1.0	EA	0.00
10	MEL00026	D03 Flow Div Sandwich Block	1.0	EA	0.00
11	MEL00027	D03 Sol Valve Sandwich Block	1.0	EA	0.00
12	MEL00030	7 Station D03 Manifold	1.0	EA	0.00
13	MFC00055	10MSAE Plug	2.0	EA	0.00
14	MFQ00088	8MSL/10MSAE Adapter	2.0	EA	0.00
15	MFQ00011	6MSL/6MSAE Adapter	2.0	EA	10.94
16	MFQ00036	8MSL/8MSAE Adapter	1.0	EA	11.53
17	MFQ00012	8MSL/8MSAE Elbow	1.0	EA	32.04
18	MFQ00061	6MSL/8MSAE Adapter	5.0	EA	10.24
19	MFQ00001	6MSL/8MSAE Elbow	6.0	EA	23.25
20	MEH00023	100-2000 Psi Sequence Valve	1.0	EA	0.00
21	MFC00048	8MSAE Plug	1.0	EA	0.00
22	MEL00038	Tapping Plate for D03 Valve	1.0	EA	0.00
23	MAC00445	#10-24NCX3-3/4LG Shcs	4.0	EA	0.00
24	MFC00029	4MSAE Plug	1.0	EA	2.88

Please visit <https://fusion.mcelroy.com/parts> to purchase parts or for more information.